

SECTION 4-A  
KICKOUT SECTION ON SUPERIOR WALL  
(BY OTHERS)  
SCALE: 1/2"=1'-0"

| EXTERIOR FINISHES        |            |                 |
|--------------------------|------------|-----------------|
| PERFECT BARRIER PACKAGE? | NO         |                 |
| COMPONENT                | MATERIAL   | COLOR (2 COATS) |
| SIDING                   | HARDIPLANK | FEDERAL BLUE    |
| FASCIA                   | HARDI      | WHITE           |
| SOFFIT                   | HARDI      | WHITE           |
| CORNER TRIM              | MIRATEC    | FEDERAL BLUE    |
| WINDOW TRIM              | MIRATEC    | WHITE           |
| DECK MATERIAL            | N/A        | N/A             |
| UNDERSKIN                | N/A        | N/A             |

| STRUCTURAL SPECIFICATIONS             |   |
|---------------------------------------|---|
| MODEL SIZE                            | 1600                                    |
| FOUNDATION TYPE                       | BASEMENT                                |
| ROOF OVERHANG                         | 3'-9" (UNVENTED)                        |
| ADDITIONAL STRUCT. REQUIREMENTS       | 2ND TENSION COLLAR PER CUSTOMER REQUEST |
| ENGINEERING REQUIRED (Y/N)            | YES                                     |
| FLOOR SYSTEM                          | 16" WEB-TEC                             |
| COLUMN HEIGHT                         | N/A                                     |
| WALL PANEL HEIGHT                     | 8'-11"                                  |
| WALL PANEL THICKNESS                  | 2X6                                     |
| SILL PLATE MATERIAL                   | S.P.F.                                  |
| FOAM (YES/NO)                         | YES                                     |
| CHIMNEY MATERIAL PROVIDED (YES/NO/NA) | NO                                      |
| EXTENDED SKIRT LENGTH                 | 19 INCHES (SEE W & D SCHEDULE)          |
| ORDER OF MATERIAL ON WALL             | STUD-CDX-FOAM-TYPAR-SIDING              |

BASED ON INFORMATION FURNISHED TO DELTEC, THIS STRUCTURE IS DESIGNED TO THE FOLLOWING MINIMUM LOADS:  
 COUNTY/REGION: LOUISA COUNTY STATE/COUNTRY: VA

|                                    |                                  |                                |
|------------------------------------|----------------------------------|--------------------------------|
| <b>ROOF LOAD INFORMATION:</b>      | <b>FLOOR LOAD INFORMATION:</b>   | <b>DECK LOAD INFORMATION:</b>  |
| LIVE LOAD TOP CHORD: 30 P.S.F.     | LIVE LOAD TOP CHORD: 40 P.S.F.   | LIVE LOAD TOP CHORD: 60 P.S.F. |
| DEAD LOAD TOP CHORD: 10 P.S.F.     | DEAD LOAD TOP CHORD: 10 P.S.F.   | DEAD LOAD TOP CHORD: 10 P.S.F. |
| DEAD LOAD BOTTOM CHORD: 10 P.S.F.  | DEAD LOAD BOTTOM CHORD: 5 P.S.F. |                                |
| WIND SPEED REQUIREMENTS: 90 M.P.H. |                                  |                                |

BY SIGNING BELOW, I UNDERSTAND IT IS MY RESPONSIBILITY TO VERIFY THIS INFORMATION IS CORRECT FOR MY BUILDING PROJECT. I AGREE NOT TO HOLD DELTEC HOMES, INC. OR ANY OF THEIR EMPLOYEES RESPONSIBLE IF IT IS LATER DETERMINED THIS INFORMATION IS NOT APPLICABLE FOR MY PROJECT. FURTHER, I UNDERSTAND THAT ANY CORRECTION TO THIS INFORMATION MUST BE MADE BEFORE I ENTER INTO MY PRODUCTION CONTRACT TO AVOID ANY REDESIGN OR REENGINEERING CHARGES.

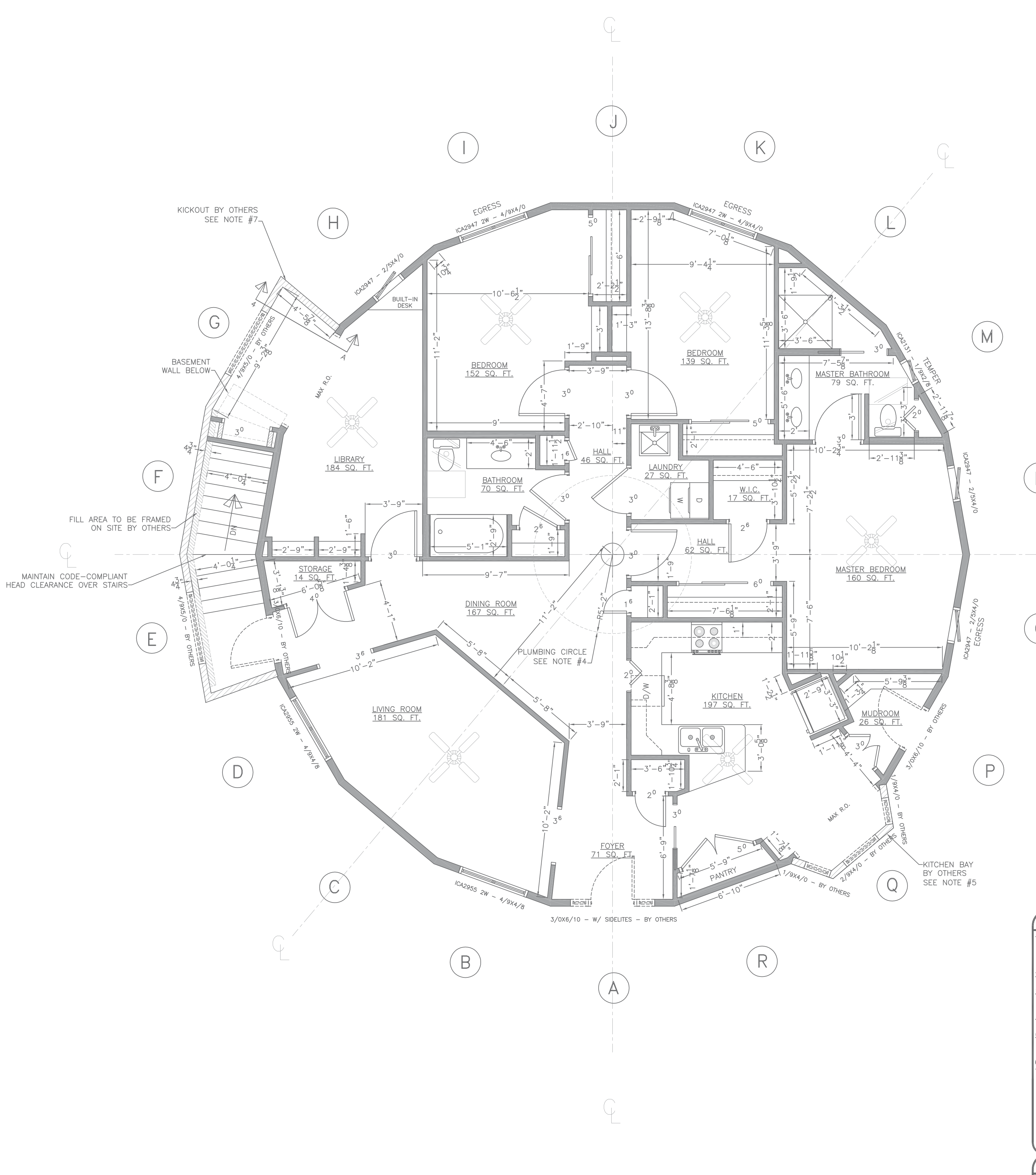

- LIST OF EXTRA MATERIALS - KICKOUT MATERIALS PROVIDED BY DELTEC:
- 17 PIECES BASIC ENERGY 1" RIGID FOAM INSULATION - 4'X8' EA.
  - 55 PIECES OF 12" HARDIPLANK SIDING - FEDERAL BLUE
  - 41 PIECES OF 8" HARDIPLANK SIDING - FEDERAL BLUE
  - 11 PIECES OF SMOOTH HARDI SOFFIT, 4'X10' - WHITE
  - 13 PIECES OF HARDI FASCIA BOARD, 12' EA. - WHITE
  - 7 PIECES MIRA-TEC TRIM BOARD, 1"X4'X16' EA. - WHITE
- ALL EXTRA MAT. TO BE DELKOTE PAINTED-2 COATS

| REVISION HISTORY (FOR DELTEC USE ONLY) |   |          |
|--|---|----------|
| REV                                    | DESCRIPTION   | DATE     |
| 01                                     | ADDED MORE DIMENSIONS.  | 03/16/08 |
| 02                                     | RE-DESIGNED INTERIOR WALLS ACCORDING TO CUSTOMER'S SPECIFICATIONS ON REVISED PLANS. UPDATED SQ. FT. ACCORDINGLY. ADJUSTED WINDOW STYLES AND SIZES. PANELS S, C, D, E & G. UPDATED GENERAL NOTES CONCERNING ADDITION OF O.T.B. FOR FUTURE ELEVATOR.  | 4/29/09  |
| 03                                     | REDREW MASTER BATH, ADDED EXTRA MAT. LIST, P.8 TO NO. ADDED COLORS TO EXT. FIN. BLOCK, TOTAL STAIRWELL WIDTH TO BE 4', REDREW SECTION 4-A, FIXED DOOR SWINGS.   | 09/26/08 |
| 04                                     | CHANGED SIDING AND CORNER TRIM COLOR TO FEDERAL BLUE; CHANGED SIDING ON PANELS E, F, & G TO SHIP LOOSE; REMOVED R.O. AND W/O NOTES FROM MISC. WINDOWS.  | 10/6/08  |
| 05                                     | MIRRORED SECTION A AND ADDED SIMPSON H2.5 TO TOPS OF WALLS. REMOVED NPC BLOCK. CHANGED STRUC. REQUIREMENTS TO PER ENG REVIEW, 2ND COLLAR REQUESTED.   | 10/28/08 |
| 06                                     | ADDED ENGINEERING NOTES.  | 11/19/08 |
| 07                                     | REDRAW FROM 0820-511.   | 4/29/09  |
| 08                                     | MOVED WINDOWS IN PANELS M, N & O.   | 5/8/09   |
| 09                                     | MODIFIED INTERIOR WALLS IN W.I.C. & KITCHEN AREAS. UPDATED SQ. FT. LISTED EXTRA MATERIALS.  | 6/9/09   |
| 10                                     | UPDATED SECTION 4-A AND STRUC. SPECS BLOCK. MOVED WALL IN M.BATH CLOSER TO TOILET, RE-SIZED DOOR IN M.BATH. MOVED WALL BETWEEN BATHS. ADDED CLOSET IN HALL. ADDED DOOR TO CLOSET IN BATH. MOVED SINK AND TOILET IN BATH AND REMOVED CLOSET NEXT TO TOILET. SWITCHED UTILITY SINK AND STACKED WASH/DRYER. ADDED COUNTER, MOVED WINDOW INTO W.I.C.. RE-SIZED DOOR IN W.I.C.. RE-SIZED WALK OUT BAY. KITCHEN/FOYER RE-DRAW.  | 05/28/10 |
| 11                                     | ADDED PLUMBING WALL IN MASTER BATH AND BATH. ADDED UNVENTED TO STRUC. SPECS. SHOWED OPERATION OF CASEMENT WINDOWS. MOVED MASTER BATH WALL 3-1/2" INTO MASTERBDRM TO MAKE ROOM FOR TOILET CLEARANCE.   | 06/03/10 |
| 12                                     | MOVED KITCHEN WITH SINK DOWN 1-3/4". MOVED KITCHEN WITH STOVE UP 3". MADE FRIDGE AREA 3" DEEPER. ADDED WALL BLUMPOUT AT BOOKSHELVES IN BEDROOMS. CHANGED HALL AT PANEL E TO 49" WIDE AND ADJUSTED STORAGE. MOVED DOOR IN PANEL E TO 110" E. RE-DESIGNED HINGE ON WINDOWS IN PANELS N AND O. CHANGED MISC. WINDOWS TO BY OTHERS. TEMPERED WINDOW IN PANEL M. CHANGED NOMINAL WIDTH OF DOOR IN PANEL P TO 3/0. ADJUSTED KICKOUT TO MATCH CHANGES TO PERIMETER PAGE LAYOUT. REMOVED W/O BLOCK. | 07/06/10 |
| 13                                     | MODIFIED NOTE #5. ADDED NOTE #6-7.  | 07/08/10 |

**GENERAL NOTES:**

- ALL WALLS (INCLUDING DELTEC PERIMETER WALLS) ARE DRAWN AS ROUGH FRAMING. ALL DIMENSIONS ARE TO ROUGH FRAMING ONLY. VERIFY WALL FINISH THICKNESS TO MAINTAIN PROPER CLEARANCES. FIELD VERIFY ROOM LAYOUTS USING ALL PROVIDED DIMENSIONS. THE CONTRACTOR OR USER OF THIS PLAN ASSUMES FINAL RESPONSIBILITY TO MEET ALL APPLICABLE BUILDING CODES AND/OR ORDINANCES.
- SQUARE FOOTAGE OF ROOMS SHOWN IS APPROXIMATE FLOOR AREA ONLY (CLOSETS, TUBS, CABINETS, ETC. ARE INCLUDED IN THIS FIGURE). DOES NOT INCLUDE INTERIOR OR EXTERIOR WALLS.
- THE STRUCTURAL DESIGN INCLUDES COMPONENTS BY DELTEC ONLY. UNLESS OTHERWISE NOTED, ADDITIONS TO THE STRUCTURE BY OTHERS SHALL BE DESIGNED BY QUALIFIED PERSONS AND SHALL NOT IMPART ADDITIONAL LOADS TO THE DELTEC STRUCTURE.
- NO 4" DRAIN PENETRATIONS WITHIN PLUMBING CIRCLE. WEB-TEC FLOOR TRUSSES CANNOT BE CUT OR MODIFIED IN ANY WAY OR THE DELTEC WARRANTY WILL BE VOID.
- KITCHEN BAY AND ANY REQUIRED WALLS AND ROOF EXTENSION, TO BE DESIGNED, SUPPLIED, AND BUILT ON-SITE BY OTHERS. DELTEC TO SUPPLY FOAM, TYPAR, AND SIDING AS LISTED ABOVE. DELTEC TO SUPPLY FLOOR TRUSSES. (1) LAYER 5/8" CDX FLOOR SHEATHING, AND FLOOR HARDWARE AS NOTED ON SHEET 6/6.
- DELTEC TO SUPPLY ERECTION JIG.
- KICKOUT, AND ANY REQUIRED ROOF AND/OR FLOOR EXTENSION, TO BE DESIGNED, SUPPLIED, AND BUILT ON-SITE BY OTHERS. DELTEC TO SUPPLY FOAM, TYPAR, AND SIDING AS LISTED ABOVE.

SCALE: 1/4" = 1'-0"  
SHEET NO: 4 OF 6

DATE: 4/27/09 JOB #: 06111 DRAWING NUMBER: 0916-544 SHEET TITLE: MAIN LEVEL FLOOR PLAN  
 DESIGNED BY: LOUISE KURYLO & MICHAEL DODD  
 PROJECT DESCRIPTION: 1 ST 1600 ON BASEMENT  
 DRAWN BY: 7e

MAIN LEVEL FLOOR PLAN

DELTEC HOMES, INC. IS THE REGISTERED SERVICE MARK OF DELTEC HOMES, INC. ALL RIGHTS RESERVED. DELTEC HOMES, INC. IS NOT RESPONSIBLE FOR ANY DAMAGE TO PROPERTY OR PERSONS ARISING FROM THE USE OF THIS PLAN. THE USER OF THIS PLAN ASSUMES ALL LIABILITY FOR ANY DAMAGE TO PROPERTY OR PERSONS ARISING FROM THE USE OF THIS PLAN. THE USER OF THIS PLAN ASSUMES ALL LIABILITY FOR ANY DAMAGE TO PROPERTY OR PERSONS ARISING FROM THE USE OF THIS PLAN. THE USER OF THIS PLAN ASSUMES ALL LIABILITY FOR ANY DAMAGE TO PROPERTY OR PERSONS ARISING FROM THE USE OF THIS PLAN.